

Project Prioritization Cover Sheet

Transportation Improvement Program



CONTACT	Contact Information		
	Agency/Organization	Herreshoff Marine Museum	
	Contact Person	William Lynn	Title Executive Director
	Mailling Address	PO Box 450	
	City	Bristol	Zip Code 02809
	Phone	(401) 253-5000 x221	Email w.lynn@herreshoff.org

PROJECT PRIORITIZATION	Project Prioritization <i>please use an additional sheet if necessary</i>			
	Priority	Listed in TIP 2013-2016		Project Name
		Yes	No	
	1		X	Herreshoff Marine Museum Rehabilitation Project

CERTIFICATION	Applicant Certification	
	The information provided on this application is in accordance with local regulations and ordinances.	
	Applicant	Executive Director
	Signature	Date

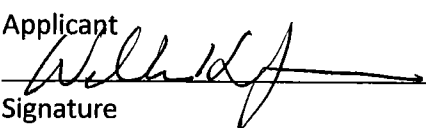
Applicant: William Lynn Title: Executive Director
 Signature:  Date: 1/8/16

New Project Application

Transportation Improvement Program



CONTACT	Contact Information
	Agency/Organization <u>Herreshoff Marine Museum</u>
	Contact Person <u>William Lynn</u> Title <u>Executive Director</u>
	Mailing Address <u>PO Box 450</u>
	City <u>Bristol, RI</u> Zip Code <u>02809</u>
Phone <u>(401) 253-5000 x221</u> Email <u>w.lynn@herreshoff.org</u>	

PROJECT INFORMATION	Type of Project <i>select all that apply</i>			
	<input type="checkbox"/> Bridge	<input type="checkbox"/> Pavement	<input type="checkbox"/> Drainage	<input type="checkbox"/> Planning
	<input type="checkbox"/> Traffic	<input type="checkbox"/> Transit	<input type="checkbox"/> Bicycle	<input type="checkbox"/> Pedestrian
	<input type="checkbox"/> Transportation Enhancement	<input type="checkbox"/> Other _____		

Project Description

Project Title Herreshoff Marine Museum Rehabilitation Project

Location by Street Name Burnside Street

Project Limits - From 22-26 Burnside Street To 28 Burnside Street

Please include an 8.5" x 11" map of the site, indicating project limits.

Provide a brief description of the proposed project:

This project involves the restoration of the exterior of the historic Burnside Building, a focal point of the Herreshoff Marine Museum campus which borders Scenic Highway 114 and, if funds permit, restoration of other adjacent historic buildings which were originally part of the Herreshoff Manufacturing Company.

The project includes:

- Restoration/repair of damaged & deteriorating East, North and West facades
- Spot repair of other facades
- Restoration of clapboard siding/trim and replacement as necessary
- Door and sill restoration/repair
- Window restoration and replacement as necessary
- Foundation masonry repair
- Restoration /replacement of gutters & downspouts
- Roof replacement/repair
- Restoration/reconstruction of the cupola and weathervane
- Prep and painting of the exterior
- Wiring replacement as necessary and prudent
- Upgrade of existing sprinklers & installation of a fire alarm system
- Addition of an elevator to provide access to the upper levels for those with mobility challenges

Phase 1 of this project is geared to make the building watertight in advance of the real restoration which is encompassed in Phase 2. Phase 1 is complete and plans for Phase 2 are at the 10% completion level.

Describe need for proposed project:

This project is important to the Herreshoff Marine Museum, an important cultural institution for the Town of Bristol and the State of Rhode Island, because one of the most important historic buildings on our campus is rapidly deteriorating. The Burnside Building served as the headquarters for the Bristol Firearms Company, makers of the Burnside Carbine, a breech-loading rifle that saw widespread use during the Civil War. The building later served as the headquarters and machine shop of the Herreshoff Manufacturing Company, designers and manufacturers of over 2,400 groundbreaking sail and steam-powered craft. HMCo. customers ranged from navies to America's Cup syndicates to private individuals, and the company and its Bristol campus are widely considered to be the cradle of Rhode Island's vibrant marine technology sector and of the state's global maritime legacy.

The project is also important to the Town of Bristol. The new Comprehensive Plan encourages investment in the town's important natural, historic and cultural resources and the Herreshoff Marine Museum is listed as one of these.

This project also delivers against specific TIP Guiding Principles including economic development, environmental impact, the support of local and state goals and equitable access for persons with disabilities (see attached for more detail on these):

Describe anticipated municipal or state transportation network or economic development benefits:

This project directly benefits the Town of Bristol by driving increased visitation to one of the region's most important cultural institutions, the Herreshoff Marine Museum, while also significantly improving the aesthetics of an historic streetscape adjacent to State Highway 114 and running between Hope Street (114) and High Street, both of which have been designated as State Scenic Roadways. Bristol's cultural institutions draw visitors from around New England, around the country and, particularly in the case of HMM, from around the world. The economic impact of these visitors is critical to area businesses.

This project will also provide work for both general contractors and historic preservation contractors in the state, and in fact, it has already done so to the tune of approximately \$487K, a total that includes funding from both DOT and the Herreshoff Marine Museum.

Is the project consistent with the local Comprehensive Plan? Yes No

Is the project on the Federal Aid System? Yes No

Is the project on the National Highway System? Yes No

Evaluation Criteria

CRITERIA

Please address the following topics as they relate to the project. Refer to "An Overview of TIP Guiding Principles" for more information. Submission **must not exceed** 2 pages, single-spaced, 12-point font.

- | | |
|-------------------------|-----------------------------------|
| 1. Mobility Benefits | 5. Supports Local and State Goals |
| 2. Cost Effectiveness | 6. Safety and Security |
| 3. Economic Development | 7. Equity |
| 4. Environmental Impact | |

Project Estimates

PROJECT ESTIMATES

	ROW	Study	Design	Construction	Total
Estimated Project Costs			\$230,000	\$1,371,000	\$1,601,000
				Total Cost	\$1,601,000
				Amount Requested through TIP Process	\$815,000

Is there funding from other sources committed to this project? Yes No

Source	Amount
Herreshoff Marine Museum	\$101,000
Earmarks	\$685,000
Total	\$786,000

Estimated date of construction September 2015

Applicant Certification

CERTIFICATION

I attest that the information provided on this application is in true and accurate.

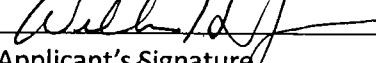
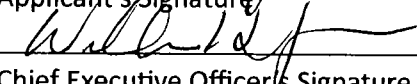
	January 8, 2016
Applicant's Signature	Date
	January 8, 2016
Chief Executive Officer's Signature	Date

ALL APPLICATIONS ARE DUE BY 3:00PM ON FRIDAY, JANUARY 8, 2016



HERRESHOFF
Marine Museum

AMERICA'S CUP
Hall of Fame

ONE BURNSIDE STREET ~ P.O. BOX 450
BRISTOL, RHODE ISLAND 02809 U.S.A.

Phone 401.253.5000
Fax 401.253.6222
Email INFO@HERRESHOFF.ORG
Web WWW.HERRESHOFF.ORG

8 January 2016

Rhode Island Statewide Planning Program
One Capitol Hill
Providence, RI 02908

RE: HERRESHOFF MARINE MUSEUM TIP NARRATIVE

The HERRESHOFF MARINE MUSEUM REHABILITATION PROJECT is an ongoing project that has gained significant momentum over the past year. The project is in mid-stream - to date, over \$386K has been spent from the initial allocation of \$1.5 million, and the museum has invested over \$100K of our own resources, plus hundreds of hours of staff time.

The Town of Bristol's new Comprehensive Plan, which is currently under review and slated for a Public Hearing on 1/12, encourages investment in the town's natural, historic and cultural resources:

"Bristol is home to a number of significant cultural institutions that are important to the identity of the Town as a historical and cultural destination for visitors as well as to residents of the Town. Among these are its numerous churches, ethnic and social clubs, the historic State House, Blithewold, Bristol Historical and Preservation Society, Coggeshall Farm, Herreshoff Marine Museum, Linden Place Museum, Mount Hope Farm and The Audubon Society Environmental Education Center. These institutions are important to both the cultural and economic aspects of Bristol, and policies that support the success and growth of these institutions should be encouraged."

The Burnside Building also comprises a significant portion of the historic Burnside streetscape which is adjacent to State Highway 114 and runs between Hope Street and High Street, both of which have been designated as State Scenic Roadways.

In addition, while the Herreshoff Marine Museum Rehabilitation Project is clearly not a typical DOT project, it does in fact support several TIP Guiding Principles:

Economic Development

This project clearly leverages past local/private investment in planning and design as the Herreshoff Marine Museum has invested over \$100K to date with BETA Inc./Glen Fontecchio Architects to complete Phase 1 of the project and bring Phase 2 to a 10% completion level. In addition, the project supports the economy of the town, region and state by attracting visitation and investment.

Environmental Impact

At the heart of this project is the enhancement of scenic resources within an historic district. The Burnside Building is an important historical structure and stands on the campus of what was one of the most important companies in building the state's incredible global maritime legacy, the Herreshoff Manufacturing Company. The building is deserving of and desperately in need of the restoration that implementation of Phase 2 of this project will provide.

Supports Local and State Goals

The Herreshoff Manufacturing Company was the largest employer in Bristol in its heyday, and the Herreshoff Marine Museum is one of the town's most important cultural institutions. Because of this, the project enjoys strong public support and is a good example of the strong partnership between the museum and the Town of Bristol.

Equity

While this project is not geared to provide access to the transportation network, Phase 2 does include the addition of an elevator to the Burnside Building, an important step toward making the entire HMM collection accessible to persons with disabilities.

Given that a significant investment has been made in the project to-date, and that the completion of Phase 1 was largely prep work for Phase 2 as opposed to a completion of any sort, we respectfully request that Statewide Planning authorize the \$815,000 allocation and prioritize the project so that we can continue the restoration of the Burnside Building and so that the \$386K of the state's money and the \$100K of the museum's money will not have been wasted.

The exterior of the Burnside Building is in poor condition and worsening quickly. The museum does not have the resources to restore the building, and we are in danger of losing not only an important historical structure but also the space inside the building which is rich with potential to generate both increased visitation and rental revenue for the Herreshoff Marine Museum. If the Enhancement funds allocated to this project are withdrawn at this point, there is a good chance that the money spent to-date will have been wasted as the building will continue to disintegrate.

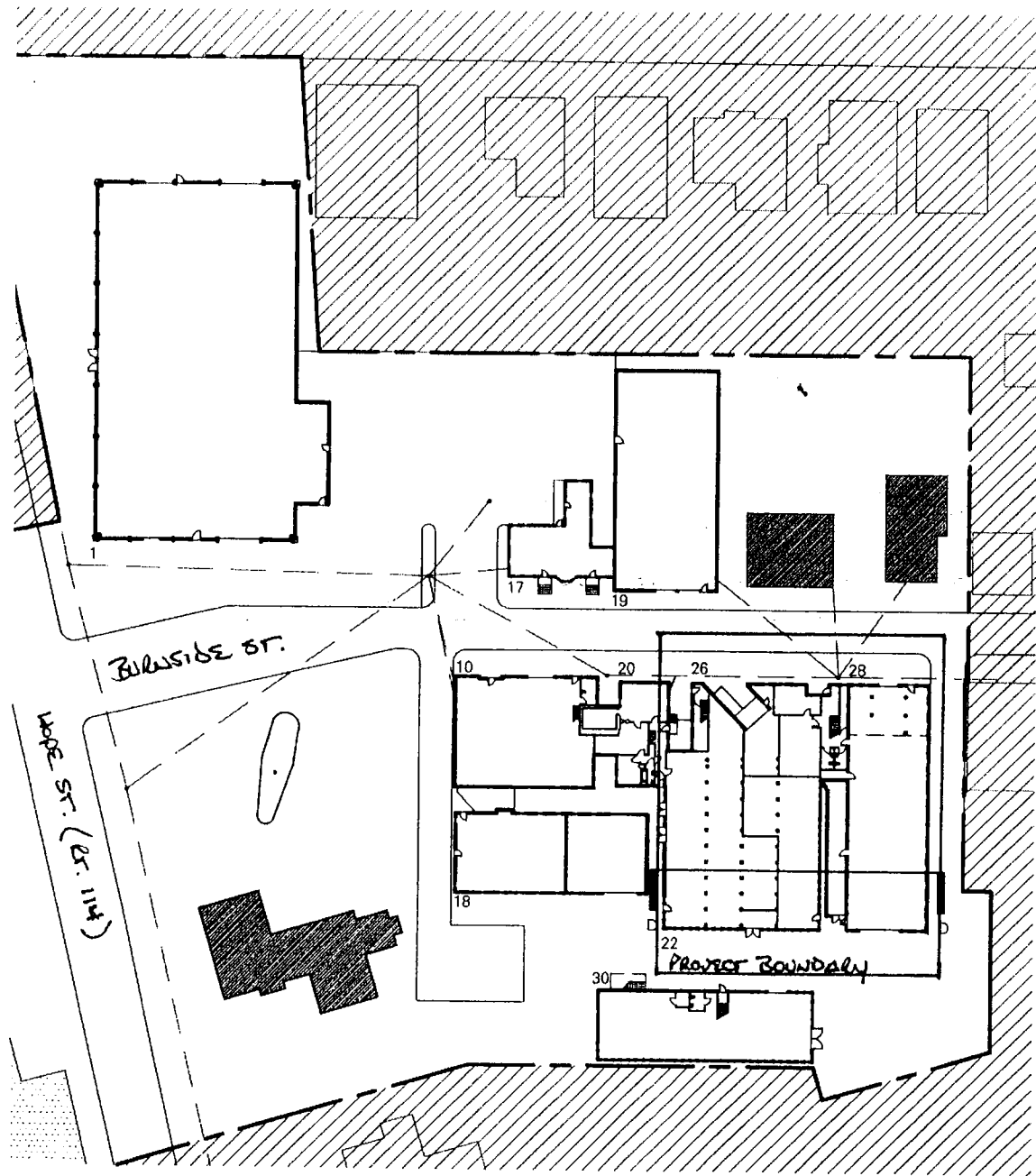

1 **SITE PLAN**
EXISTING CONDITIONS

1/64" = 1'-0"

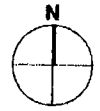

WILLIAM KITE ARCHITECTS, INC.
166 Valley Street
Building Five
Providence, Rhode Island 02909
TEL 401 372.0240
FAX 401 351.8986
www.kitearchitects.com

Herreshoff
Manna Complex Renovation Study

Project No. 0922

B.0



TOWN OF BRISTOL, RHODE ISLAND
OFFICE OF TOWN ADMINISTRATOR

ANTONIO A. TEIXEIRA
Town Administrator

January 8, 2016

Ms. Karen Scott
Assistant Chief
RI Statewide Planning Program
1 Capitol Hill
Providence, RI 02908

RE: Herreshoff Marine Museum Rehabilitation Project

Ms. Scott:

This letter is to inform you and the other members of the Project Evaluation Subcommittee that the Town of Bristol is aware of, and supports the restoration of the Burnside Building at 22-26 Burnside Street in Bristol.

I can also attest that the project conforms to the Town of Bristol Comprehensive Plan as it is directly intended to protect the historic and cultural resources that link Bristol's present with Bristol's past.

As the Herreshoff Marine Museum is located in one of Bristol's historic districts, any exterior renovation project must secure a permit from the Bristol Historic District Commission.

Kind regards,

Antonio A. Teixeira
Town Administrator